

OREGON PUBLIC LAND CORNER REPORT / RESTORATION REPORT
Tillamook County Surveyor's Office

BOOK 8 204

SECTION: 12 and 7	TOWNSHIP: 4 South	RANGE: 10 and 11 West
COUNTY: Tillamook		DATE: 01/2024
CORNER DESIGNATION: The Quarter Corner common to Sections 7, Township 4 South, Range 10 West and Section 12, Township 4 South, Range 11 West, Willamette Meridian, Tillamook County, Oregon.		(Please check one)
		<input type="checkbox"/> Condition Report Only
		<input type="checkbox"/> Restoration
		<input checked="" type="checkbox"/> Rewitness
		<input type="checkbox"/> Unrecorded
		<input type="checkbox"/> Reset at surface
		<input type="checkbox"/> Referenced Out

Previous Rewitnesses, Restorations and Surveys, etc... BLM Field Note Volume: OR-R0112 Page 085 (1872), BLM Field Note Volume: OR-R0180 Page 064 (1879), Rewitness Bk. 4 pg. 99 (1961), Rewitness Card #723 (1976), B-828 (1979), B-1282 (1987), A-5904 (1989), P-36 (1990), Rewitness Bk. 7 pg. 22 (1990), B-1628 (1992), C-473 (1997), P-410 (1997), B-2275 (1999), B-2332 (2000).

History, condition, and sources: In ±1872 Contract #166 (BLM Field Note Volume: OR-R0112 Page 085) J. W. Meldrum, Deputy Surveyor set Post with charred stake in mound of earth with pits. In ±1879 Contract # 301 (BLM Field Note Volume: OR-R0180 Page 064) Henry Meldrum, Deputy Surveyor set a 4"x 4" Fir Post and established 2 Bearing Trees. In 1961 (Rewitness Bk. 4 pg. 99) W.E. Anderson reset corner with a 2" Iron Pipe and established 2 Bearing Trees. In 1976 (Rewitness Card #723) Tillamook County Surveyor's Office found a 1 1/2" Iron Pipe plugged and tacked set by G.M. and G.A. in 1968. Tillamook County Surveyor's Office set a 2" Iron Pipe with a 3" Tillamook County Surveyor's Brass Cap in 10" tile and cement in position of found 1 1/2" Iron Pipe. The two GLO Bearing Trees were gone. The two Bearing Trees set by Anderson were found and a Hat Section Post was added. In 2003 the Hat Section Post was replaced. In 1987 (B-1282) Jim S. Peterson found two Bearing Trees uprooted and established 2 new Bearing Trees. In 1990 (Rewitness Bk. 7 pg. 22) Tillamook County Surveyor's Office set 2 new accessories, a 5/8" x 10" Iron Rod with a red Tillamook County Surveyor's Plastic Cap in the middle of a 29" Spruce stump and a 5/8" x 10" Iron Rod with a red Tillamook County Surveyor's Plastic Cap in the middle of a 22" Spruce stump. In 1992 (B-1628) Leonard A. Rydell found a 3" Tillamook County Surveyor's Brass Cap in concrete, a White Paddle and an Orange Witness Post of unknown origin. In 2024 Tillamook County Surveyor's Office found a 3" Tillamook County Surveyor's Brass Cap in concrete in good condition as shown hereon.

Not Found: (BLM Field Note Volume: OR-R0180 Page 064) 20" Fir, N 70° W 52 Links

Not Found: (BLM Field Note Volume: OR-R0180 Page 064) 30" Fir, N 28° E 58 Links

Not Found: (Rewitness Bk. 4 pg. 99) 24" Spruce, N 34° W 10.0'

Not Found: (Rewitness Bk. 4 pg. 99) 30" Spruce, S 85° E 7.8'

Not Found: (B-1282) 24" Spruce, S 17° W 44.9'

Not Found: (B-1282) 28" Spruce, S 30° E 46.6'

Not Found: (Rewitness Bk. 7 pg. 22) 5/8"x 10" Iron Rod with a red Tillamook County plastic cap in middle of a 22" Spruce stump S 4° E 29.46'

Found: (Rewitness Bk. 7 pg. 22) 5/8"x 10" Iron Rod with a red Tillamook County Surveyor's plastic cap in middle of a 29" Spruce stump N 73° E 24.87', Now Spruce stump badly rotted, no Iron Rod

Found: (Rewitness Card #723) Hat Section West 1.0'. Post out of position. Reset South 1.5'

New accessories set:

The Monument was tied conventionally using G.P.S. established control. The coordinates have been converted and are provided here in WGS 84, Latitude and Longitude.

Latitude: 45° 14' 19.61"

Longitude: -123° 57' 56.63"

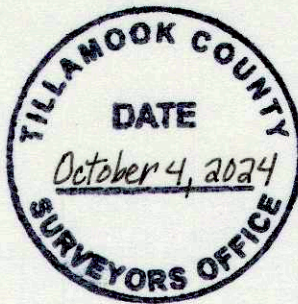

Pictures of Found Monuments:



Location: From Sandlake-Woods County Road take Nantucket Drive to the intersection of Southview Loop. Corner is located approximately S 45° E 200' The corner is located at the edge of a Spruce stand.

Tillamook County Surveyor office: 1510 3rd Street Suite C, Tillamook, OR. 97141

Party Chief: Travis Porter, Tillamook County Survey Office

Witnesses: Michael Rice, P.L.S. 86926, Tillamook County Surveyor
Kael Poklikuha, Tillamook County Survey Technician

Notes: Digital images taken of monument and accessories.

SURVEYOR'S SEAL

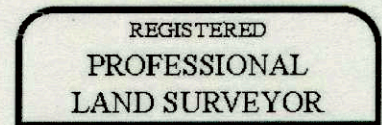

RENEWAL 12-31-2024

BOOK 8 204